

# HOW to use the ROCKET STOVE

1

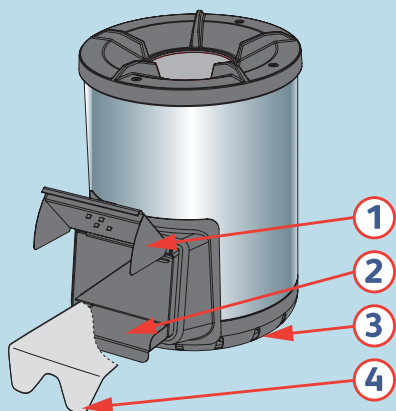

The rocket stove runs efficiently and can heat water quickly. PLEASE read all instructions before use.

Place the stove on an even, steady surface. Make sure that the lower air supply openings are not covered in order to ensure an optimal air supply.

1. Feeding door (open position)
2. Ash box
3. Lower air supply
4. Fuel support

**NEVER  
CUT DOWN  
TREES OR  
BRANCHES  
FOR FIRE  
WOOD**

2



Place one firelighter in the tunnel of the stove and some dry kindling around it. Light the firelighter.

Once the kindling is alight, feed the fire with small dry branches found on the ground or small sticks of kindling.

Please do not cut or break branches off the trees.

3

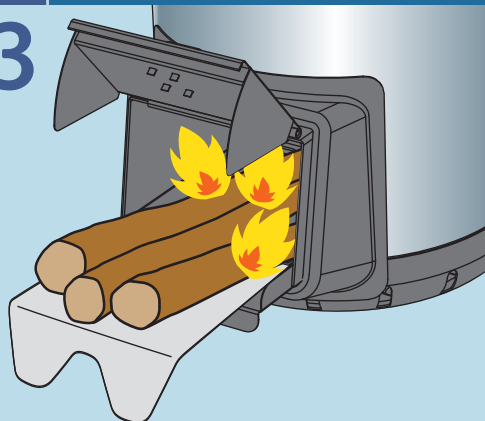

To fuel the rocket stove, lift the feeding door and push the wood in. Open the door only to add more fuel. Ideally keep it closed to ensure an optimal burn.

The fuel support pulls out to place wood on that is ready to go in or it can support longer bits of wood as they are fed into the stove.

Once you have finished cooking, let the fire in the stove burn out.

Never pour water to extinguish the fire in the rocket stove.

Once the rocket stove has cooled down, pull the ash box out of the combustion chamber and dispose of the ashes.

4

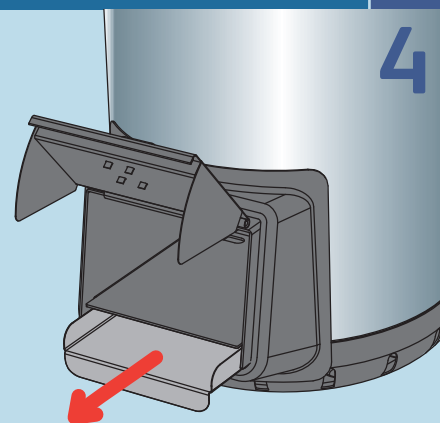

## CAUTION!

1. Do not leave the stove unattended while lit.
2. The rocket stove can become very hot and flames can escape from the upper opening.
3. Children and animals should never be allowed near the stove.
4. Do not attempt to move the stove while lit.
5. Keep a safe distance to flammable and heat-sensitive objects and avoid long, loose sleeves as they can catch fire easily.
6. Let the rocket stove completely cool down after use.

## HOW to use the BUSH SHOWER

1



**NEVER  
CUT DOWN  
TREES OR  
BRANCHES  
FOR FIRE  
WOOD**

Enjoy the sights and sounds of nature whilst taking a shower outdoors – it's a really fun way to get clean!

Light the fire pit or wood burning rocket stove and fill the large 5 litre kettle from the sink or standpipe. Then place the kettle on the fire and wait for it to boil. Use only the wood that we provide or fallen twigs found on the ground for the wood stove. Plan ahead and warm some extra water on the stove in the yurt or hut.

Pour the boiled water into the yellow bucket and mix in 10 litres of cold water which will give a warm shower of about 3 minutes. Adjust amount of cold water to suit your preferred temperature. Do the elbow test rather than relying on your hands to gauge the temperature!

2

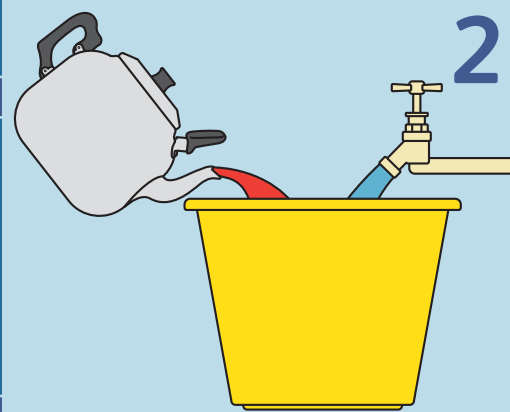

3

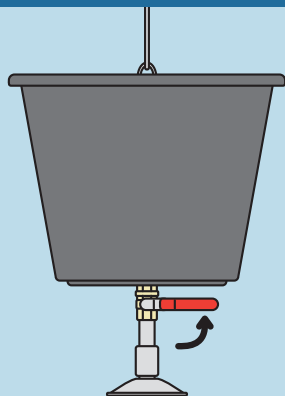

Make sure the red shower lever under the shower bucket is in the off portion and horizontal. Then unhook the shower rope; lower the shower bucket and hook onto the loop in the rope.

Check shower bucket and clear out any leaves before pouring in your warm water.

Pull the rope to lift the shower bucket up high and attach the loop to the hook to make it secure.

4

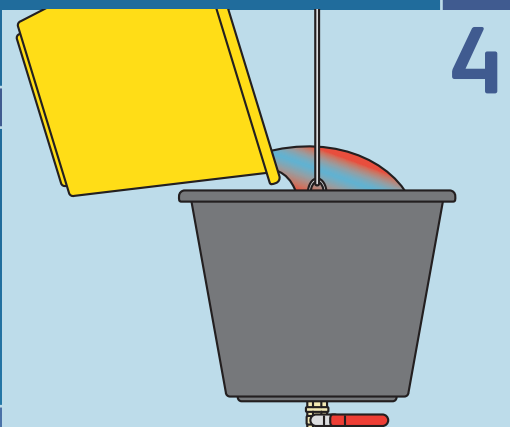

5

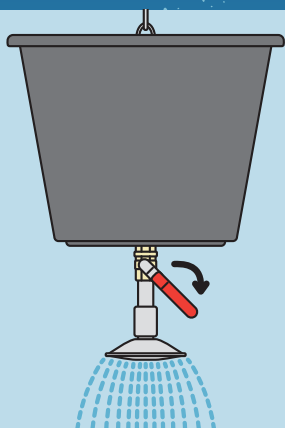

Stand under the shower and pull the red handle downwards until you have the flow rate you prefer (a faster rate will mean a shorter shower). Then relax and enjoy your Wild shower! These showers are part of the adventure at Wild Northumbrian, there is no instant switch but this is all part of the fun.

**Please  
take care  
throughout  
the process.  
BOILING  
WATER  
SCALDS**